



PONDEROSA



Log Home



2,336 ft²



Next to
Bikini Pond



2 Kings
4 Twins



2 Baths

Granite Lodge



3 min.



1 min.

Rod & Gun



10 min.



5 min.

*Enclosed porch with a fireplace
is cozy any time of year*

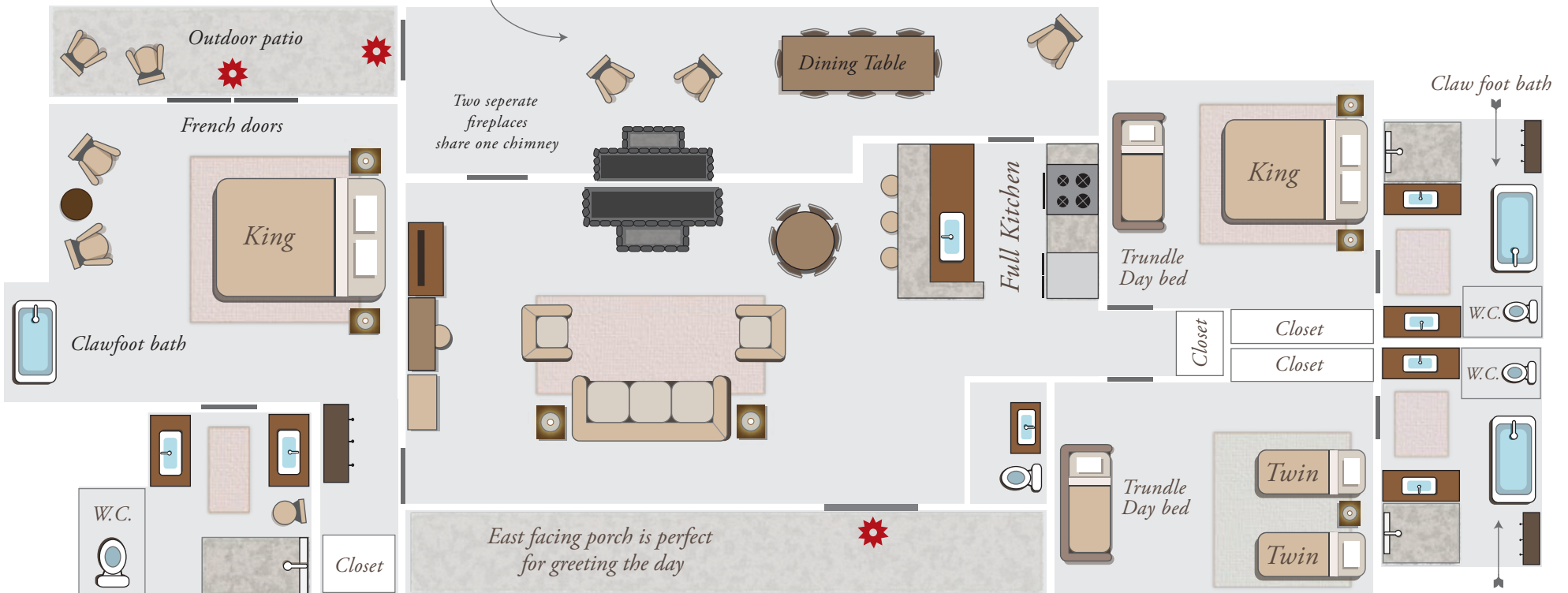

Across from
Bikini Pond



A short walk to
the **Granite Lodge**



Near the
Swimming Pool



**Accommodation can sleep up to 10 guests.
Additional cost for capacity over 6 people.*